

- WARNING & DISCLAIMER**
1. These plans (marked 17426-CC) have been produced to for Information ONLY and SHALL NOT be used for Construction.
 2. Under NO circumstance SHALL they be used for Construction
 3. This set of plans is Conceptual and is subject to Development Approval, service locations and Final designs by other parties. Accordingly the any grades, designs, levels and location of the structures / Roads etc may vary to suit those designs
 4. ANY and ALL levels shown within this set of drawings are based on the detail survey completed by Bath Stewart Associates on 06.07.2017. The final location of services may influence the design levels shown
 5. Services, existing and proposed are NOT Shown within this set of drawings
 6. Background survey information has been manipulated from aerial photos and the information shown HAS NOT been confirmed by any updated topographic & details survey
 7. Design information provided is conceptual and has not been finalised

DESIGN FOR INFORMATION ONLY - NOT FOR CONSTRUCTION

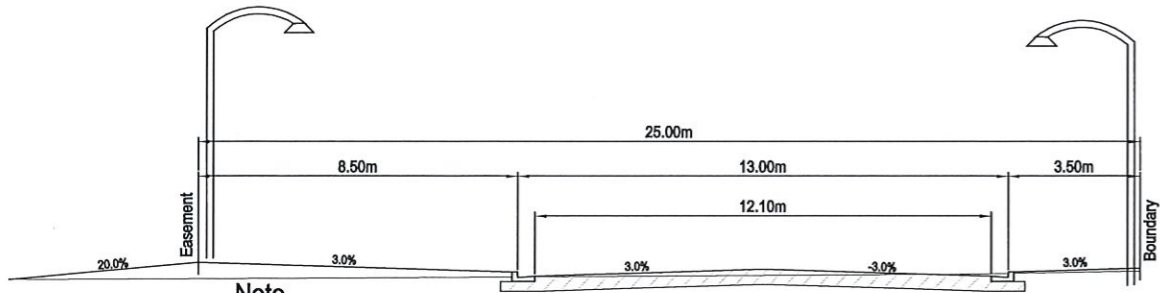
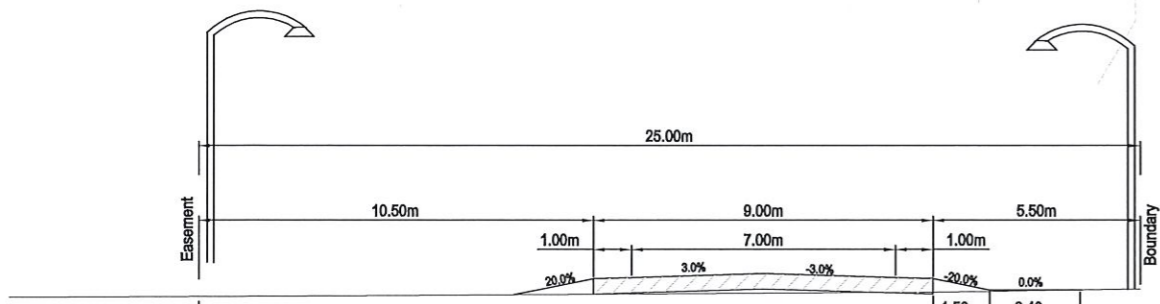
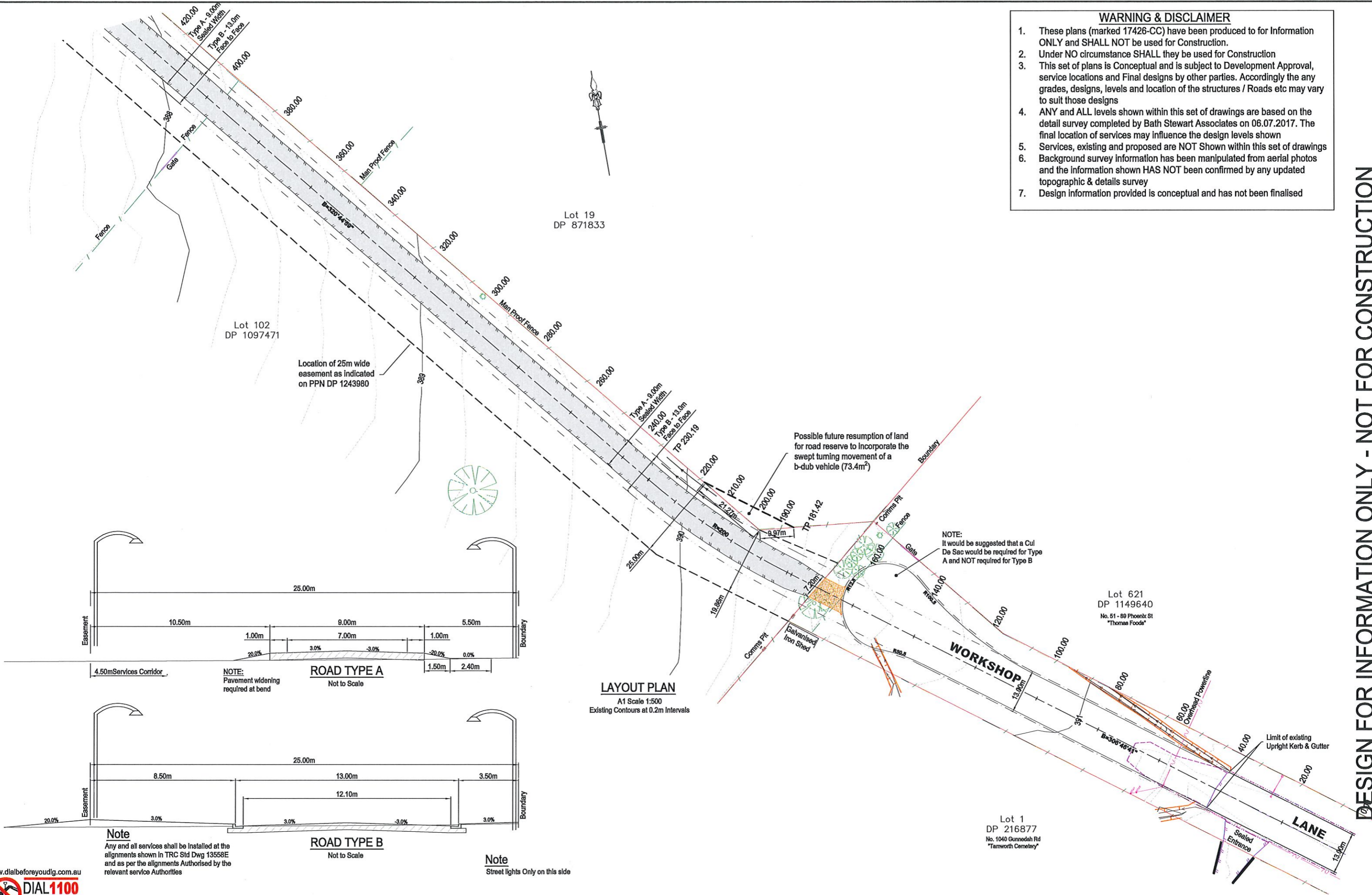

LAYOUT PLAN
A1 Scale 1:500
Existing Contours at 0.2m Intervals

NOTE:
Pavement widening
required at bend

NOTE:
It would be suggested that a Cul
De Sac would be required for Type
A and NOT required for Type B

Note
Any and all services shall be installed at the
alignments shown in TRC Std Dwg 13558E
and as per the alignments Authorised by the
relevant service Authorities

Note
Street lights Only on this side



LEGEND (EXISTING - LIGHT PROPOSED - DARKER)	Rev.	DESCRIPTION	APPROVED	DATE	Cad:	Original A1 Drawing Scale Bar:	BATH STEWART ASSOCIATES DEVELOPMENT CONSULTANTS SURVEYORS - ENGINEERS - PLANNERS - PROJECT MANAGERS 239 Marius Street TAMWORTH NSW 2340 Telephone (02) 6766 5966 A.C.N. 002 745 020 office@bathstewart.com.au	BAIADA PTY LTD OAKBURN RENDERING PLANT 1154 GUNNEDAH ROAD, WESTDALE LOT 100 DP 1097471 - PROPERTY ACCESS EASEMENT ROADWORKS (DA -----) LAYOUT PLAN & TYPICAL SECTION (SH 02 of 02)	Ref. No: 17426-AC Sheet No: 01 of 06 Revision: A
CENTRE LINE KERB AND GUTTER TOP OF BATTER SURFACE DRAINAGE FENCING LINE SEAL SEWER MAIN WATER MAIN (& SIZE) STORMWATER DRAINAGE OVERHEAD POWER UNDERGROUND ELECTRICAL TREE SHRUB SIGN SEWER MANHOLE, INSPECTION PIT DOWNPIPE & ROOFWATER OUTLET POWER POLE STREETLIGHT GUIDE POST WATER (HYDRANT, VALVE, METER) TELSTRA PIT AND CABLES					17426-AC 17426V13 Survey: M.BEATH Drawn: M.BEATH Designed: M.BEATH Checked: D.LORD	A1 Scale 1:500 5.0 0.0 6.0 10.0 Datum Description: SSM 39850 RL 387.674 Located on the Eastern side of Gunnedah Road, 105m north of Baiada Entrance			

- WARNING & DISCLAIMER**
1. These plans (marked 17426-CC) have been produced for Information ONLY and SHALL NOT be used for Construction.
 2. Under NO circumstance SHALL they be used for Construction
 3. This set of plans is Conceptual and is subject to Development Approval, service locations and Final designs by other parties. Accordingly the any grades, designs, levels and location of the structures / Roads etc may vary to suit those designs
 4. ANY and ALL levels shown within this set of drawings are based on the detail survey completed by Bath Stewart Associates on 06.07.2017. The final location of services may influence the design levels shown
 5. Services, existing and proposed are NOT Shown within this set of drawings
 6. Background survey information has been manipulated from aerial photos and the information shown HAS NOT been confirmed by any updated topographic & details survey
 7. Design information provided is conceptual and has not been finalised

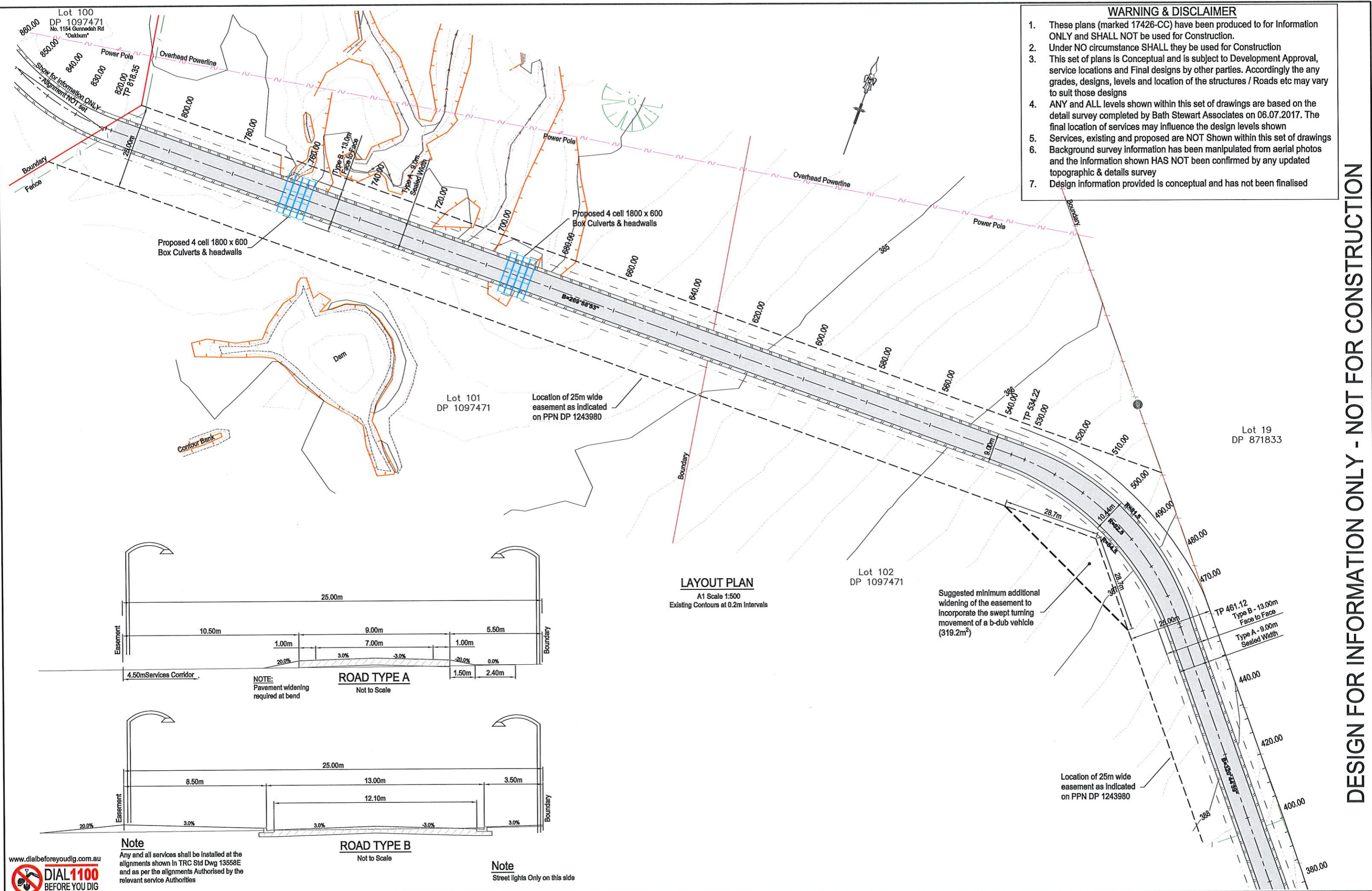

LAYOUT PLAN
A1 Scale 1:500
Existing Contours at 0.2m Intervals

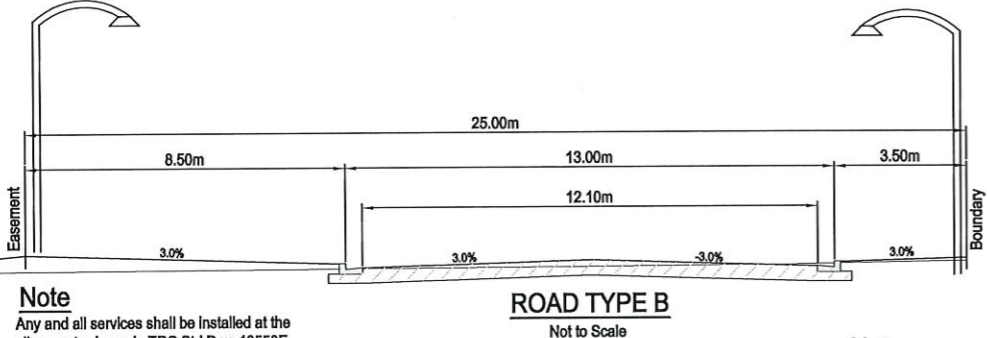
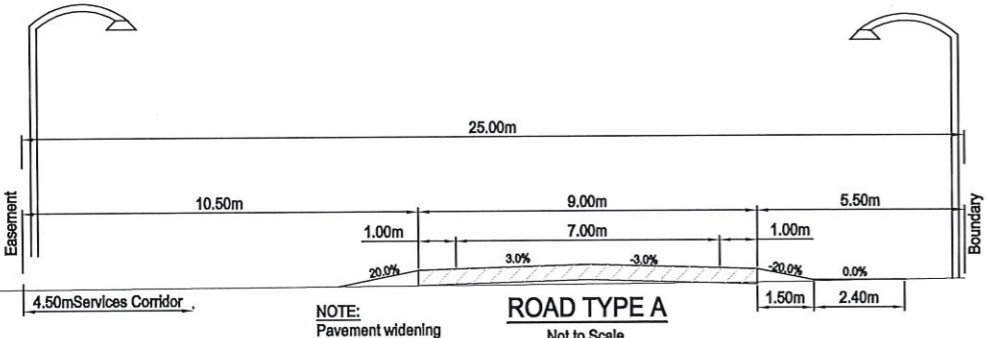

Note
Any and all services shall be installed at the alignments shown in TRC Std Dwg 13558E and as per the alignments authorised by the relevant service Authorities

Note
Street lights Only on this side

www.dialbeforeyoudig.com.au

DIAL 1100 BEFORE YOU DIG

LEGEND (EXISTING - LIGHT PROPOSED - DARKER)	Rev.	DESCRIPTION	APPROVED	DATE
CENTRE LINE				
KERB AND GUTTER				
TOP OF BATTER				
SURFACE DRAINAGE				
EDGE OF BITUMEN SEAL				
FENCING LINE				
SEWER MAIN				
WATER MAIN (& SIZE)				
STORMWATER DRAINAGE				
OVERHEAD POWER				
UNDERGROUND ELECTRICAL				

Rev.	DESCRIPTION	APPROVED	DATE
A	ISSUED FOR CLIENT INFORMATION	D.LORD	31.08.18

Cad: 17426-AC
Civilload: 17426V13
Survey: M.BEATH
Drawn: M.BEATH
Designed: M.BEATH
Checked: D.LORD

Original A1 Drawing Scale Bar:
A1 Scale 1:500
60 0.0 6.0 100

Datum Description:
SSM 39850 RL 387.674
Located on the Eastern side of Gunnedah Road, 105m north of Baiada Entrance

BATH STEWART ASSOCIATES
DEVELOPMENT CONSULTANTS
SURVEYORS - ENGINEERS - PLANNERS - PROJECT MANAGERS
239 Marius Street TAMWORTH NSW 2340
Telephone (02) 6766 5966 A.C.N. 002 745 020

office@bathstewart.com.au

This document / plan / drawing / sketch is the copyright property of Bath Stewart Associates Pty Ltd and shall not be copied or reproduced in part or whole, in any media without written approval, nor shall it be used except for the Development and Site Specified

BAIADA PTY LTD
OAKBURN RENDERING PLANT
1154 GUNNEDAH ROAD, WESTDALE
LOT 100 DP 1097471 - PROPERTY ACCESS EASEMENT ROADWORKS (DA -----)

Ref. No: 17426-AC
Sheet No: 02 of 06
Revision: A

LAYOUT PLAN & TYPICAL SECTION (SH 02 of 02)

©Bath Stewart Associates Pty Ltd

DESIGN FOR INFORMATION ONLY - NOT FOR CONSTRUCTION

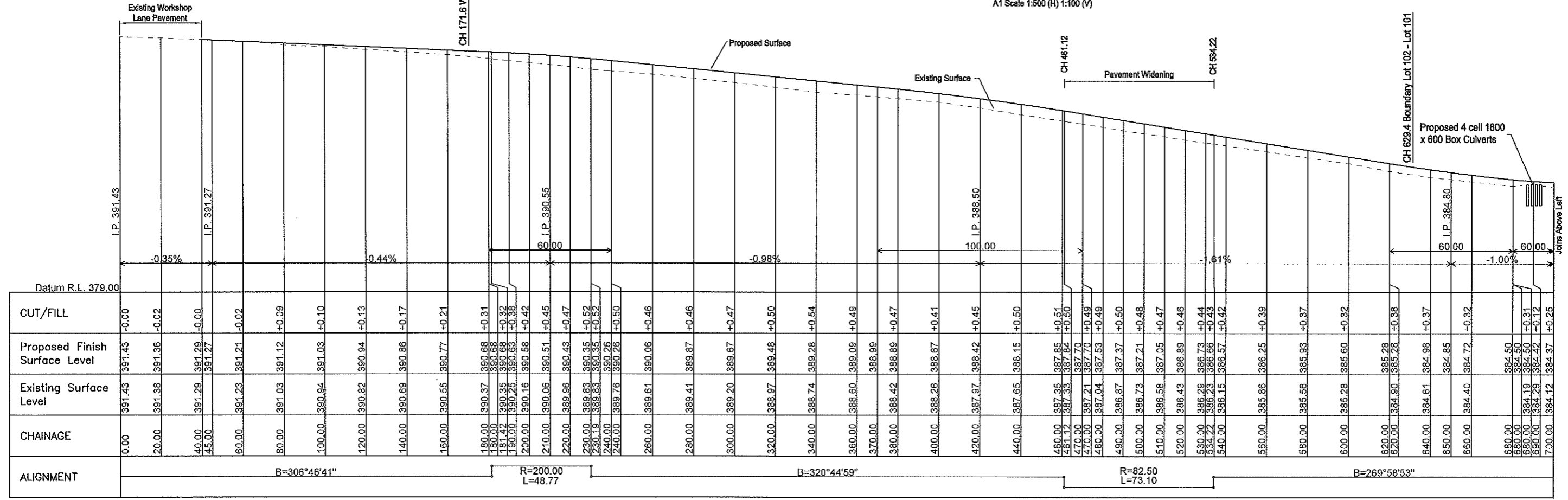
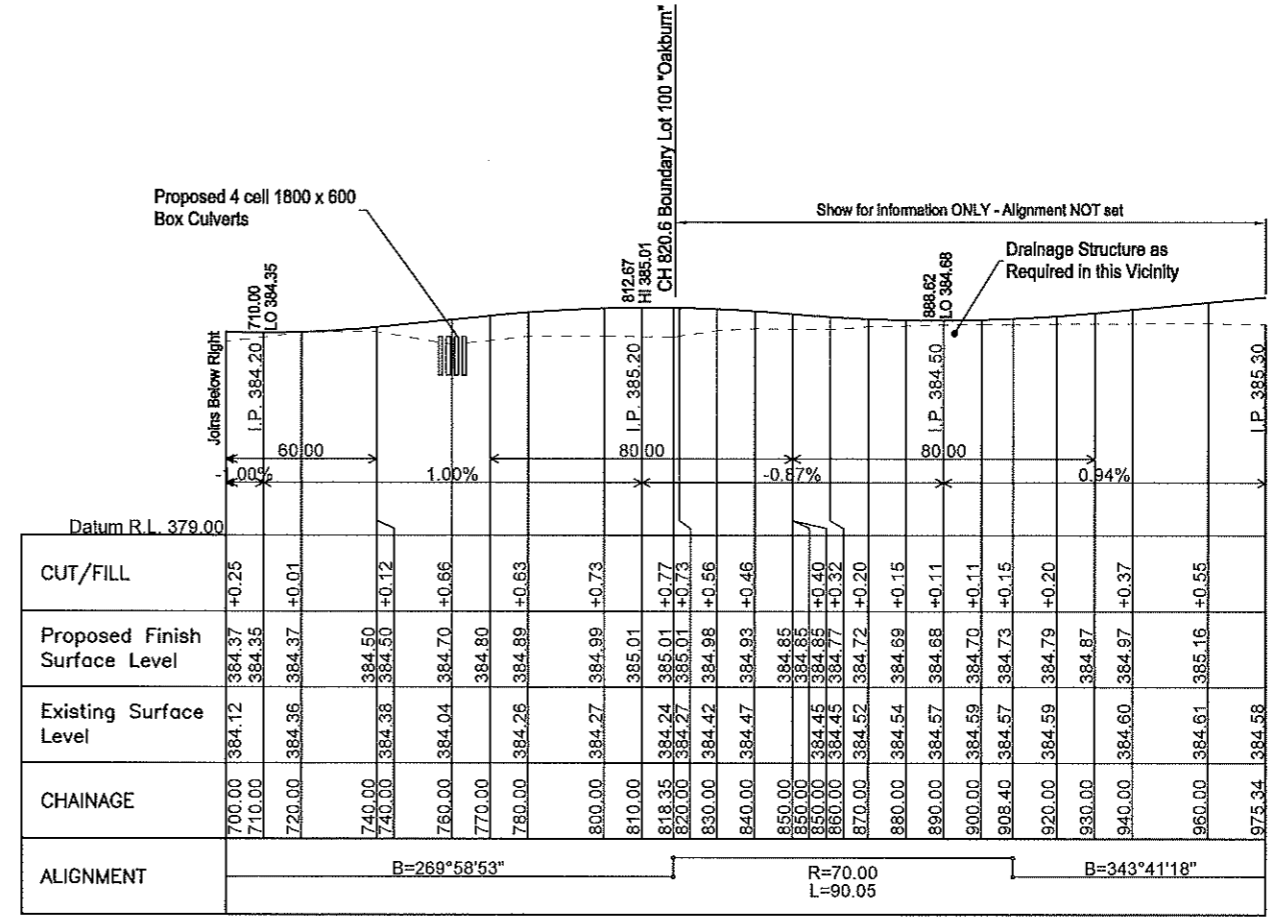

www.dialbeforeyoudig.com.au
DIAL 1100
 BEFORE YOU DIG

LEGEND (EXISTING - LIGHT PROPOSED - DARKER)	Rev.	DESCRIPTION	APPROVED	DATE
CENTRE LINE				
KERB AND GUTTER				
TOP OF DRAIN				
SURFACE DRAINAGE				
EDGE OF BITUMEN SEAL				
FENCELINE				
WATERMAIN (& SIZE)				
STORMWATER DRAINAGE				
OVERHEAD POWER				
UNDERGROUND ELECTRICAL				
TREE				
SHRUB				
SIGN				
SEWER MANHOLE, INSPECTION PIT				
DOWNPIPE & ROOFWATER OUTLET				
POWER POLE				
STREETLIGHT				
WATER (HYDRANT, VALVE, METER)				
GUIDE POST				
TELSTRA FIT AND CABLES				
A		ISSUED FOR CLIENT INFORMATION	D.LORD	31.08.18

Cad: 17426-AC
 Civilload: 17426V13
 Survey: M.BEATH
 Drawn: M.BEATH
 Designed: M.BEATH
 Checked: D.LORD

BATH STEWART ASSOCIATES
 DEVELOPMENT CONSULTANTS
 SURVEYORS - ENGINEERS - PLANNERS - PROJECT MANAGERS
 239 Marius Street TAMWORTH NSW 2340
 Telephone (02) 8766 5966 A.C.N. 002 745 020

office@bathstewart.com.au

This document / plan / drawing / sketch is the copyright property of Bath Stewart Associates Pty Ltd and shall not be copied or reproduced in part or whole, in any media without written approval, nor shall it be used except for the Development and Site Specified

BAIADA PTY LTD
OAKBURN RENDING PLANT
 1154 GUNNEDAH ROAD, WESTDALE
 LOT 100 DP 1097471 - PROPERTY ACCESS EASEMENT
 ROADWORKS (DA -----)

LONGITUDINAL SECTION

Ref. No:
17426-AC
 Sheet No: **03 of 06**
 Revision: **A**
 ©Bath Stewart Associates Pty Ltd

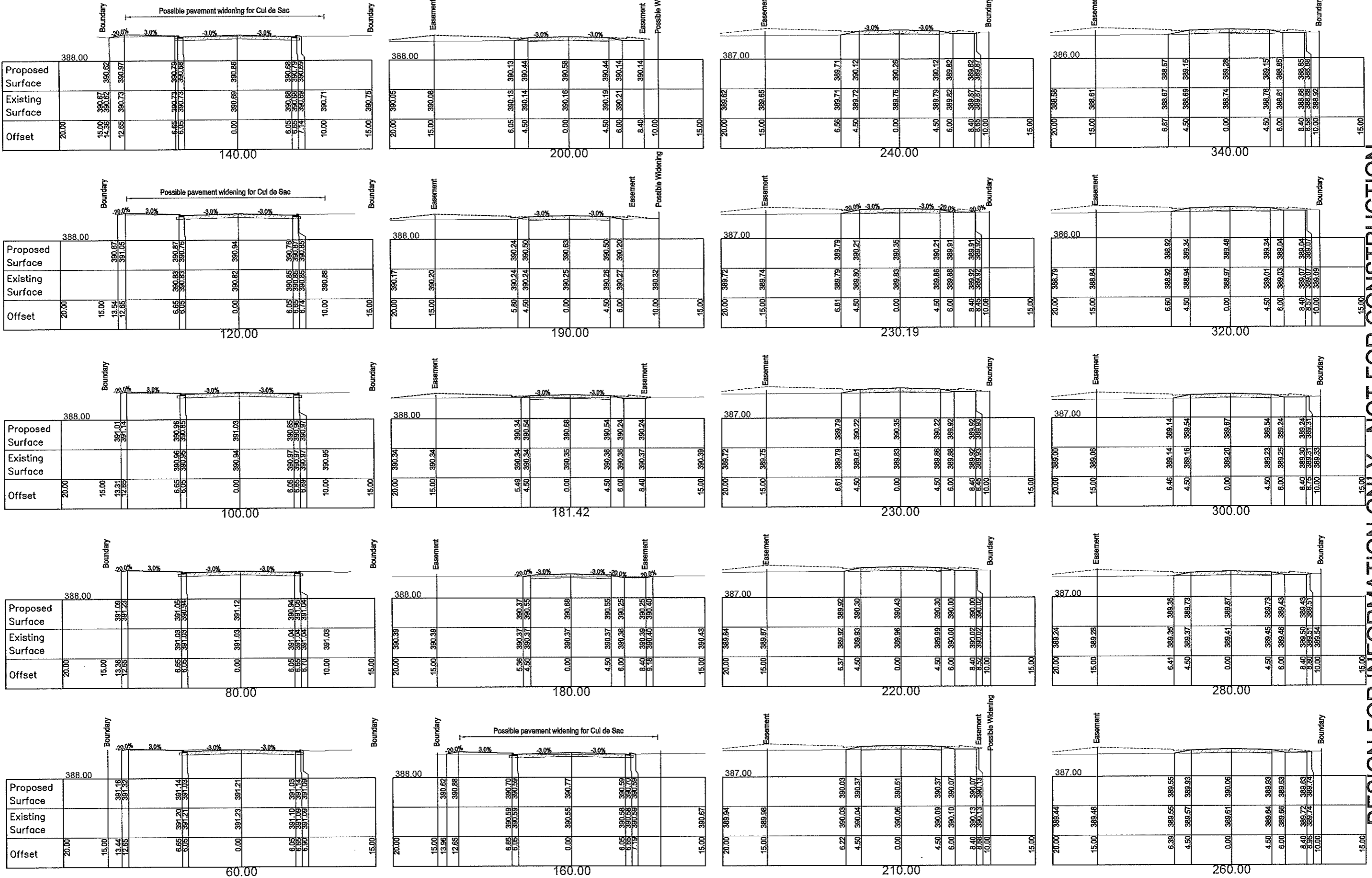

LEGEND (EXISTING - LIGHT PROPOSED - DARKER)	REV.	DESCRIPTION	APPROVED	DATE
CENTRE LINE				
KERB AND GUTTER				
TOP OF BATTER				
SURFACE DRAINAGE				
EDGE OF BITUMEN SEAL				
FENCIBLE				
SEWERMAIN				
WATERMAIN (& SIZE)				
STORMWATER DRAINAGE				
OVERHEAD POWER				
UNDERGROUND ELECTRICAL				
TREE				
SHRUB				
SIGN				
SEWER MANHOLE, INSPECTION PIT				
DOWNPIPE & ROOFWATER OUTLET				
POWER POLE				
STREETLIGHT				
GUIDE POST				
WATER (HYDRANT, VALVE, METER)				
TELSTRA PIT AND CABLES				

Cad:	17426-AC
Civilload:	17426V13
Survey:	M.BEATH
Drawn:	M.BEATH
Designed:	M.BEATH

BATH STEWART ASSOCIATES
 DEVELOPMENT CONSULTANTS
 SURVEYORS - ENGINEERS - PLANNERS - PROJECT MANAGERS
 239 Maris Street TAMWORTH NSW 2340
 Telephone (02) 8766 5986 A.C.N. 002 745 020
 office@bathstewart.com.au

Original AI Drawing Scale Bar:
 A1 Scale 1:200 (0) 2.0 0.0 2.0 4.0
 A2 Scale 1:400 (0) 1.0 0.0 1.0 2.0 4.0
 A1 Scale 1:200 (V)

Return Description:
 SSM 39850 RL 387.674
 Located on the Eastern side of Gunnedah Road, 105m north of Baiada Entrance

This document / plan / drawing / sketch is the copyright property of Bath Stewart Associates Pty Ltd and shall not be copied or reproduced in part or whole, in any media without written approval, nor shall it be used except for the Development and Site Specified.

BAIADA PTY LTD
OAKBURN RENDERING PLANT
 1154 GUNNEDAH ROAD, WESTDALE
 LOT 100 DP 1097471 - PROPERTY ACCESS EASEMENT
 ROADWORKS (DA -----)
 CROSS SECTIONS (CH 60.00 to 340.00)

Ref. No:	17426-AC
Sheet No:	04 of 06
Revision:	A

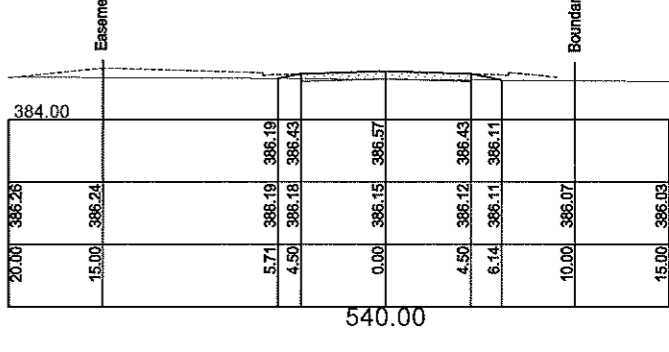
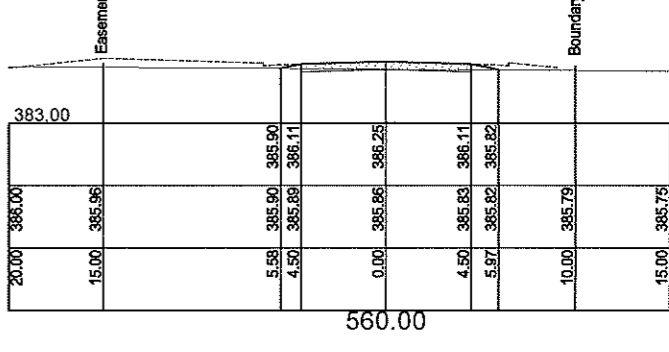
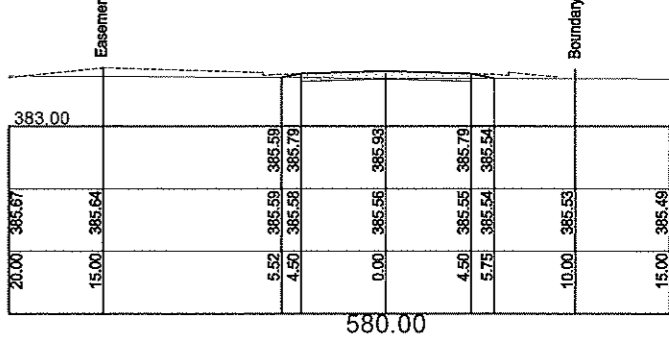
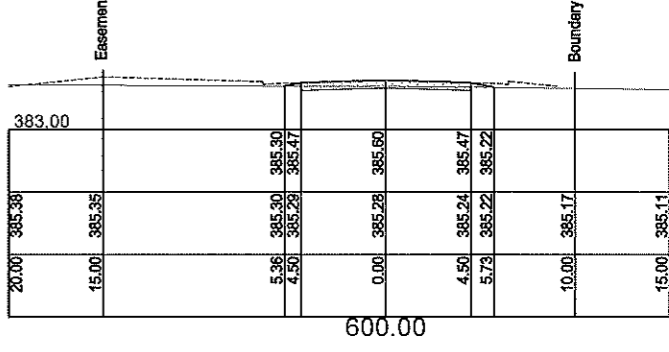
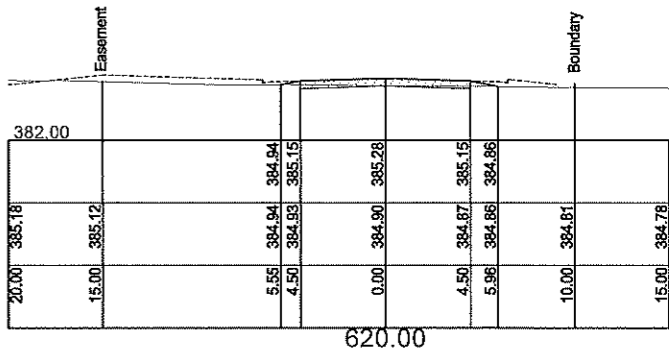
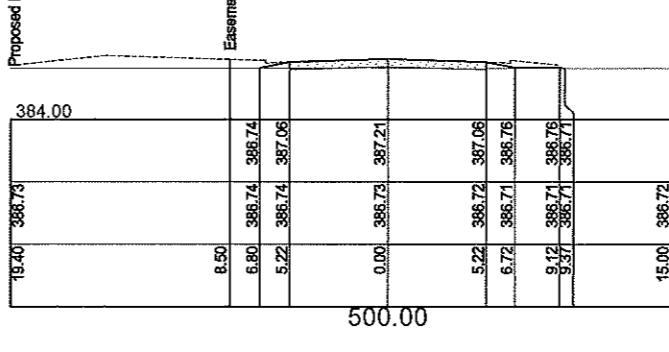
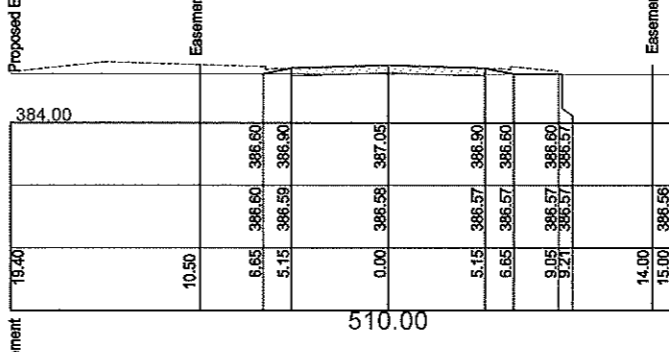
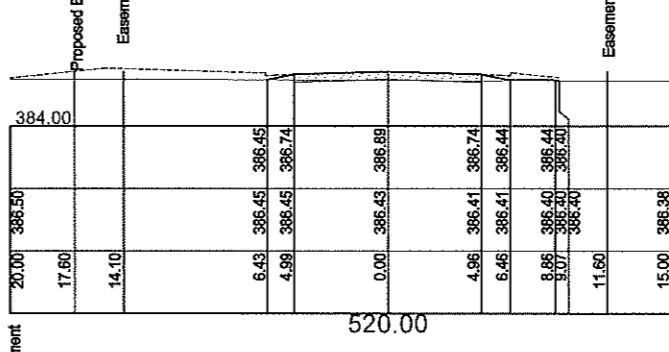
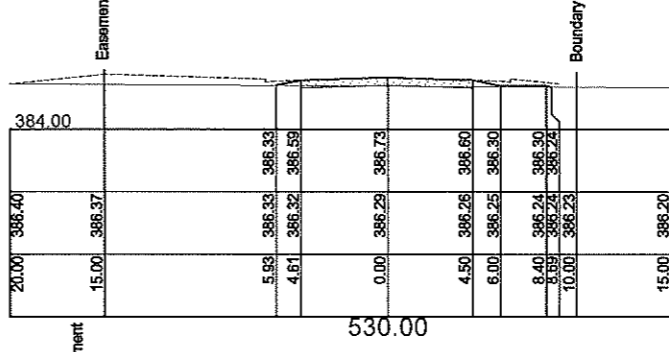
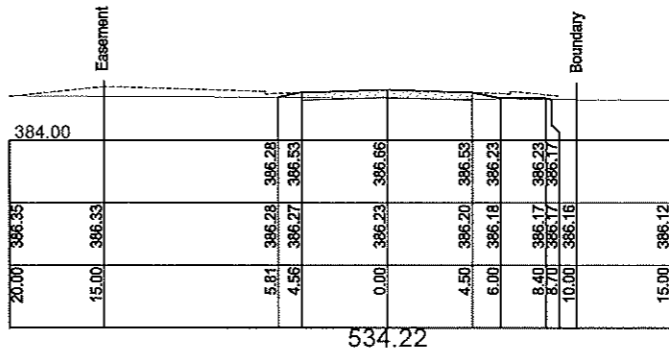
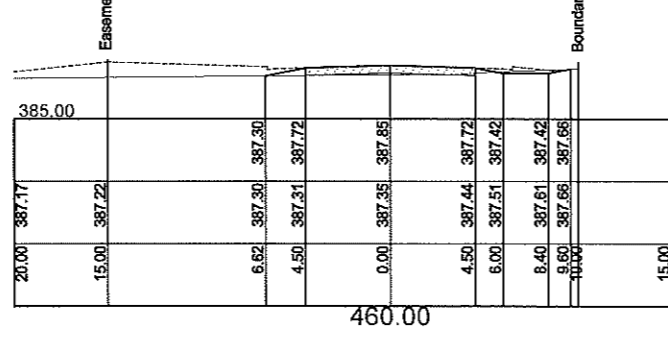
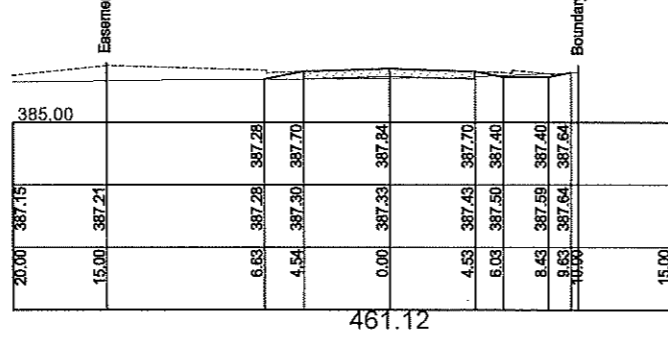
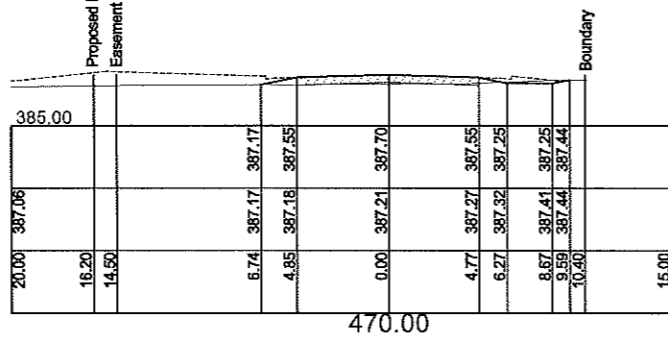
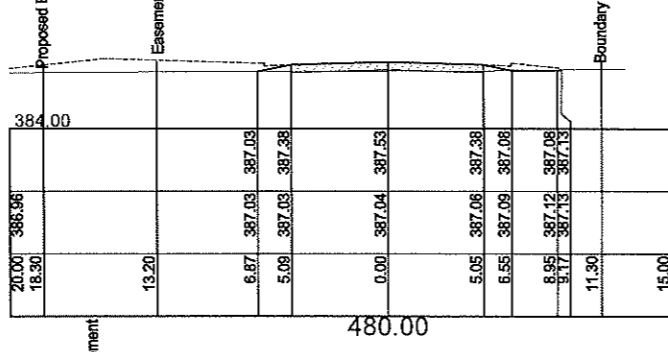
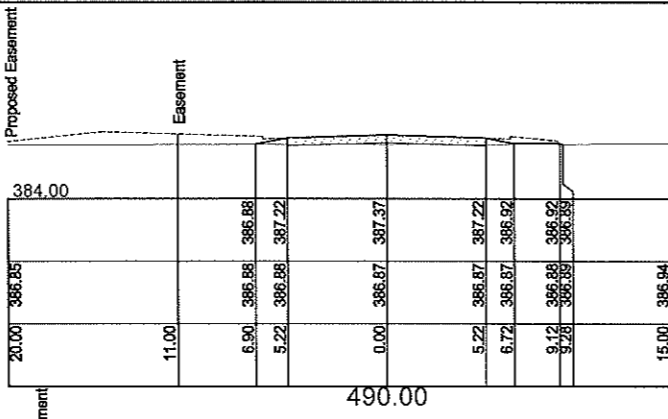
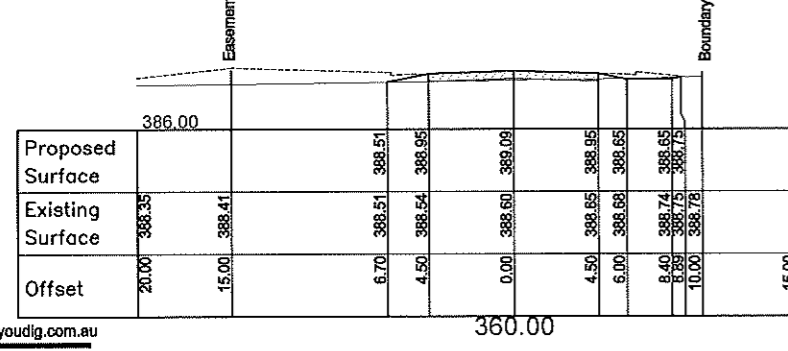
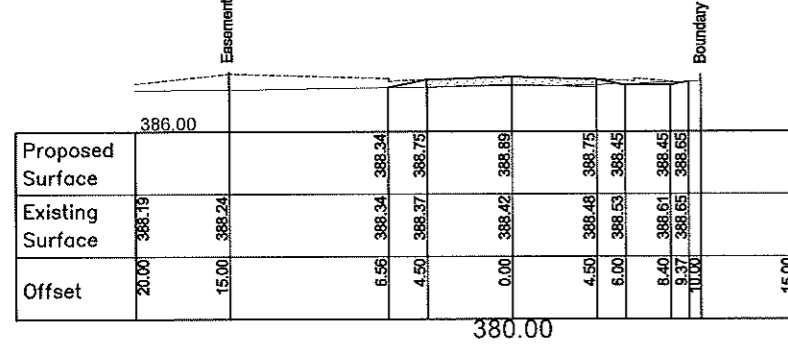
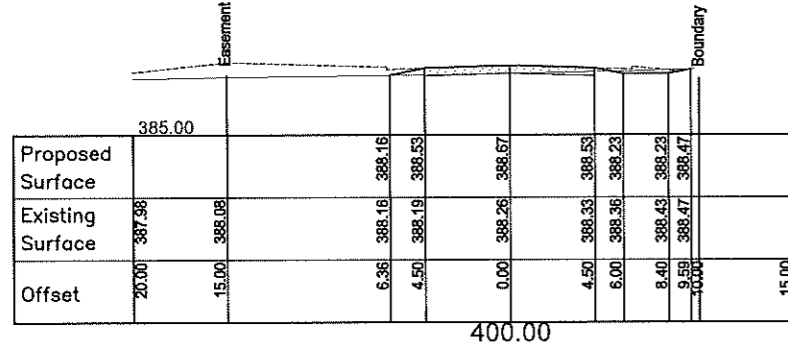
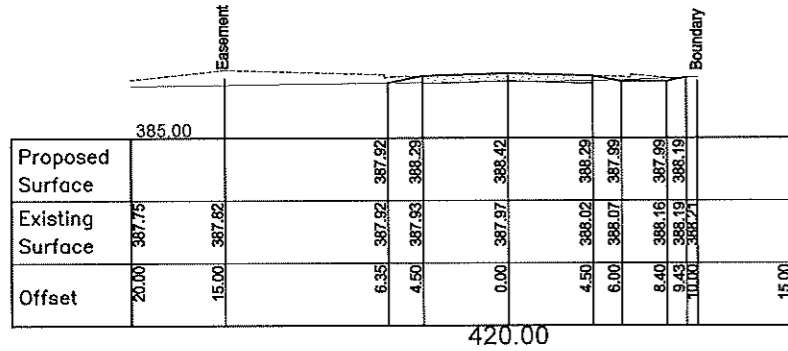
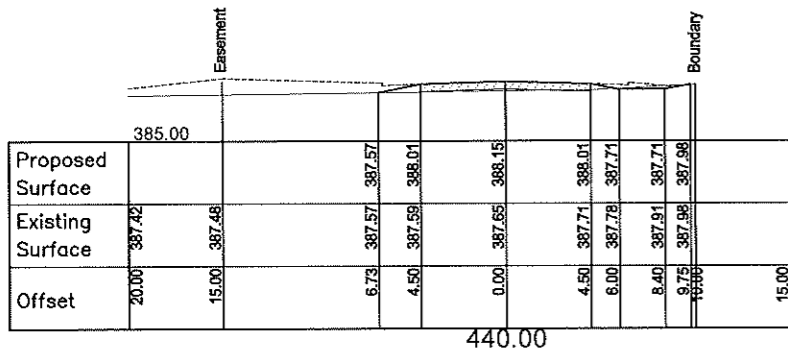

www.dialbeforeyoudig.com.au



LEGEND (EXISTING - LIGHT PROPOSED -- DARKER)	Rev.	DESCRIPTION
CENTRE LINE		
KERB AND GUTTER		
TOP OF BATTER		
SURFACE DRAINAGE		
EDGE OF BITUMEN SEAL		
FENCING		
SEWER MAIN		
WATERMAIN (& SIZE)		
STORMWATER DRAINAGE		
OVERHEAD POWER		
UNDERGROUND ELECTRICAL		
TREE		
SHRUB		
SIGN		
SEWER MANHOLE, INSPECTION PIT		
DOWNPIPE & ROOFWATER OUTLET		
POWER POLE		
STREETLIGHT		
GUIDE POST		
WATER (HYDRANT, VALVE, METER)		
TELSTRA PIT AND CABLES		

Rev.	DESCRIPTION
A	ISSUED FOR CLIENT INFORMATION

APPROVED	DATE
D.LORD	31.08.18

Cad: 17426-AC	Original AI Drawing Scale Bar:
Civiload: 17426V13	At Scale 1:200 (H)
Survey: M.BEATH	At Scale 1:200 (V)
Drawn: M.BEATH	
Designed: M.BEATH	
Checked: D.LORD	

BATH STEWART ASSOCIATES
 DEVELOPMENT CONSULTANTS
 SURVEYORS - ENGINEERS - PLANNERS - PROJECT MANAGERS
 239 Marius Street TAMWORTH NSW 2340
 Telephone (02) 6766 5966 A.C.N. 002 745 020
 office@bathstewart.com.au

BAIADA PTY LTD
OAKBURN RENDERING PLANT
 1154 GUNNEDAH ROAD, WESTDALE
 LOT 100 DP 1097471 - PROPERTY ACCESS EASEMENT
 ROADWORKS (DA -----)
 CROSS SECTIONS (CH 360.00 to 620.00)

Ref. No:	17426-AC
Sheet No:	05 of 06
Revision:	A

DESIGN FOR INFORMATION ONLY - NOT FOR CONSTRUCTION

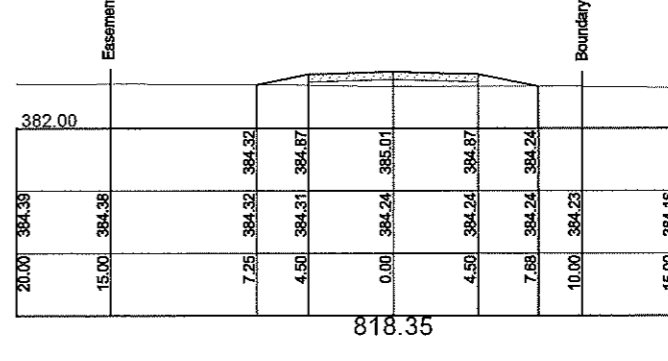
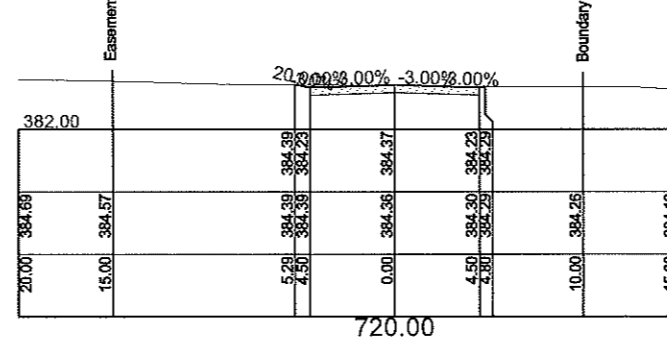
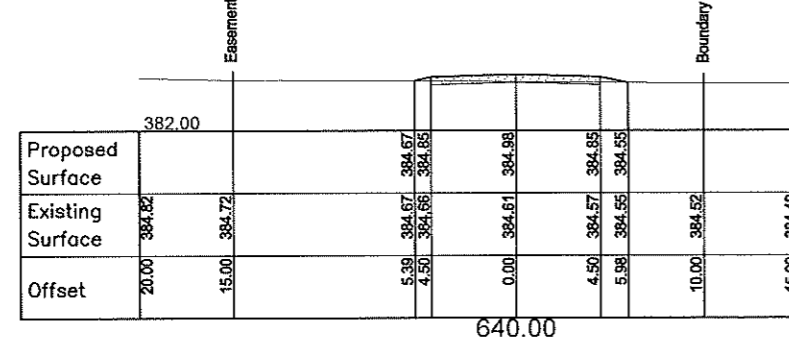
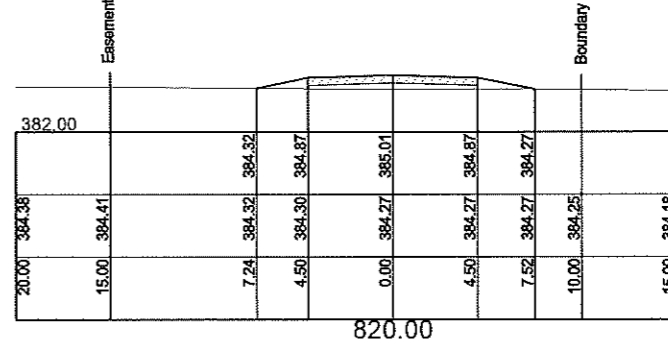
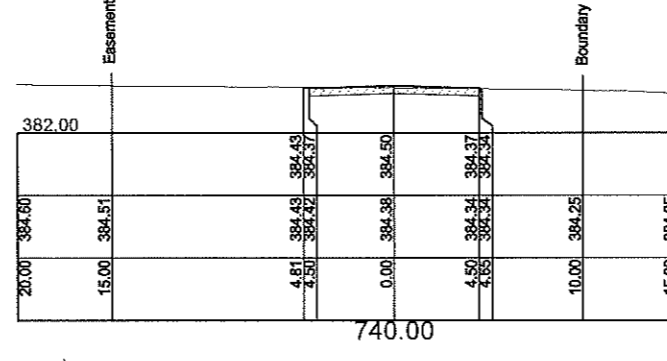
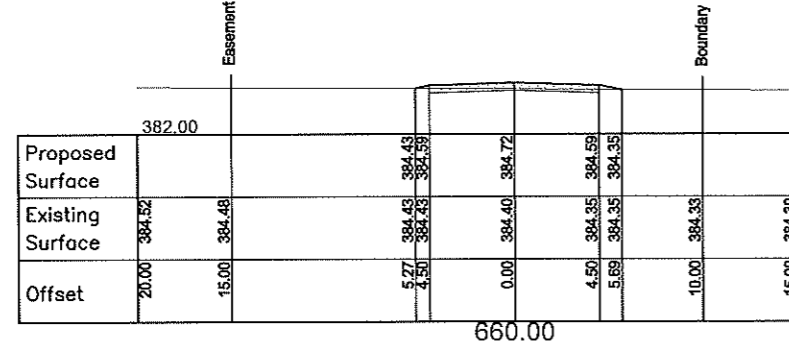
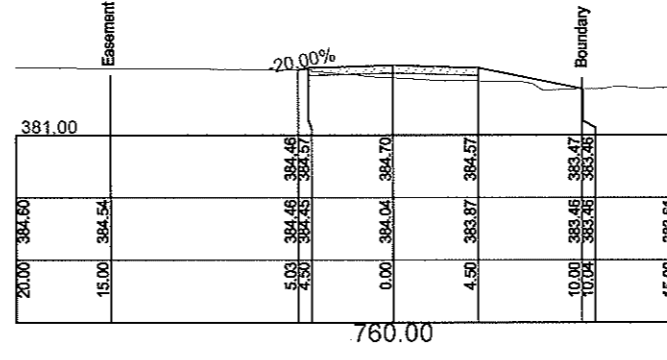
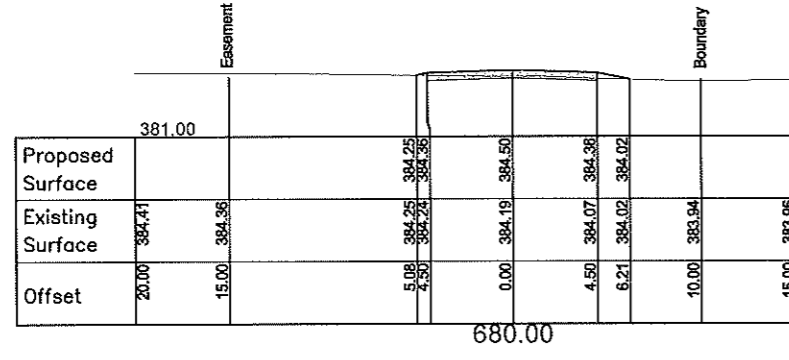
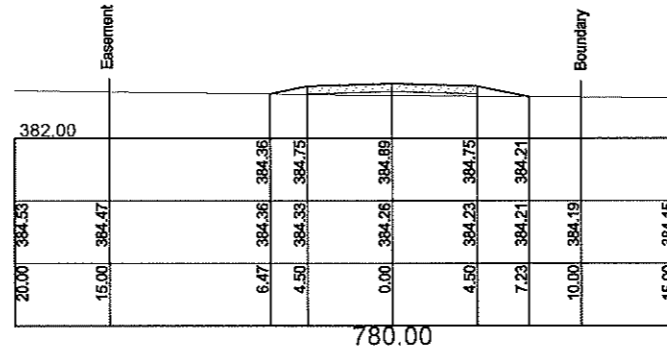
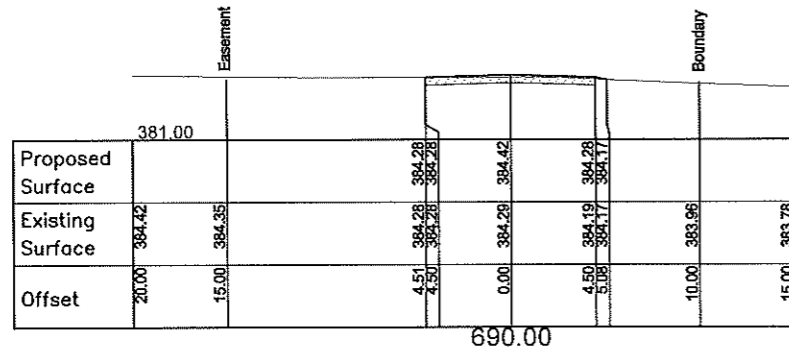
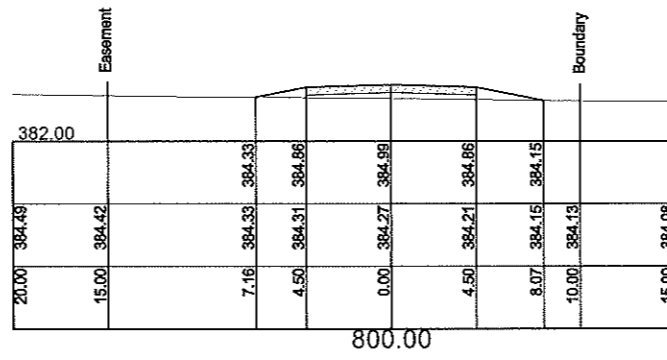
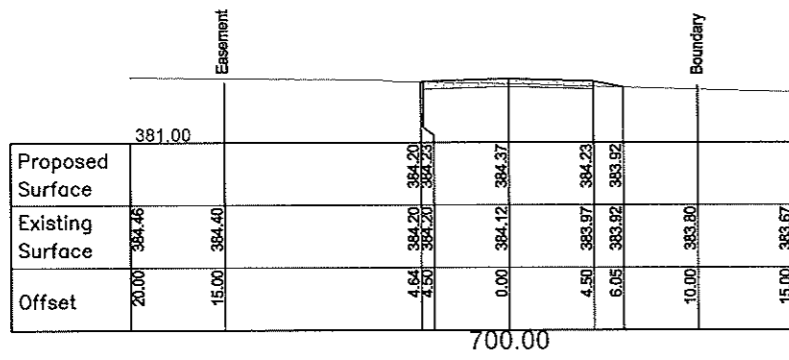

LEGEND (EXISTING - LIGHT PROPOSED - DARKER)	Rev.	DESCRIPTION	APPROVED	DATE
CENTRE LINE				
KERB AND GUTTER				
TOP OF BATTER				
SURFACE DRAINAGE				
EDGE OF BITUMEN SEAL				
FENCELINE				
SEWERMAN				
WATERMAIN (& SIZES)				
STORMWATER DRAINAGE				
OVERHEAD POWER				
UNDERGROUND ELECTRICAL				

Rev.	DESCRIPTION	APPROVED	DATE
A	ISSUED FOR CLIENT INFORMATION	D.LORD	31.08.18

Cad:	17426-AC
Civilload:	17426V13
Survey:	M.BEATH
Drawn:	M.BEATH
Designed:	M.BEATH
Checked:	D.LORD

BATH STEWART ASSOCIATES
 DEVELOPMENT CONSULTANTS
 SURVEYORS - ENGINEERS - PLANNERS - PROJECT MANAGERS
 239 Marius Street TAMWORTH NSW 2340
 Telephone (02) 6766 5966 A.C.N. 002 745 020
 office@bathstewart.com.au

BAIADA PTY LTD
OAKBURN RENDERING PLANT
 1154 GUNNEDAH ROAD, WESTDALE
 LOT 100 DP 1097471 - PROPERTY ACCESS EASEMENT
 ROADWORKS (DA -----)
 CROSS SECTIONS (CH 640.00 to 820.00)

Ref. No:	17426-AC
Sheet No:	06 of 06
Revision:	A